

Wild, Scenic and Recreational Rivers (WSRR) 50 Lot Subdivision Acreage Within WSRR Boundary

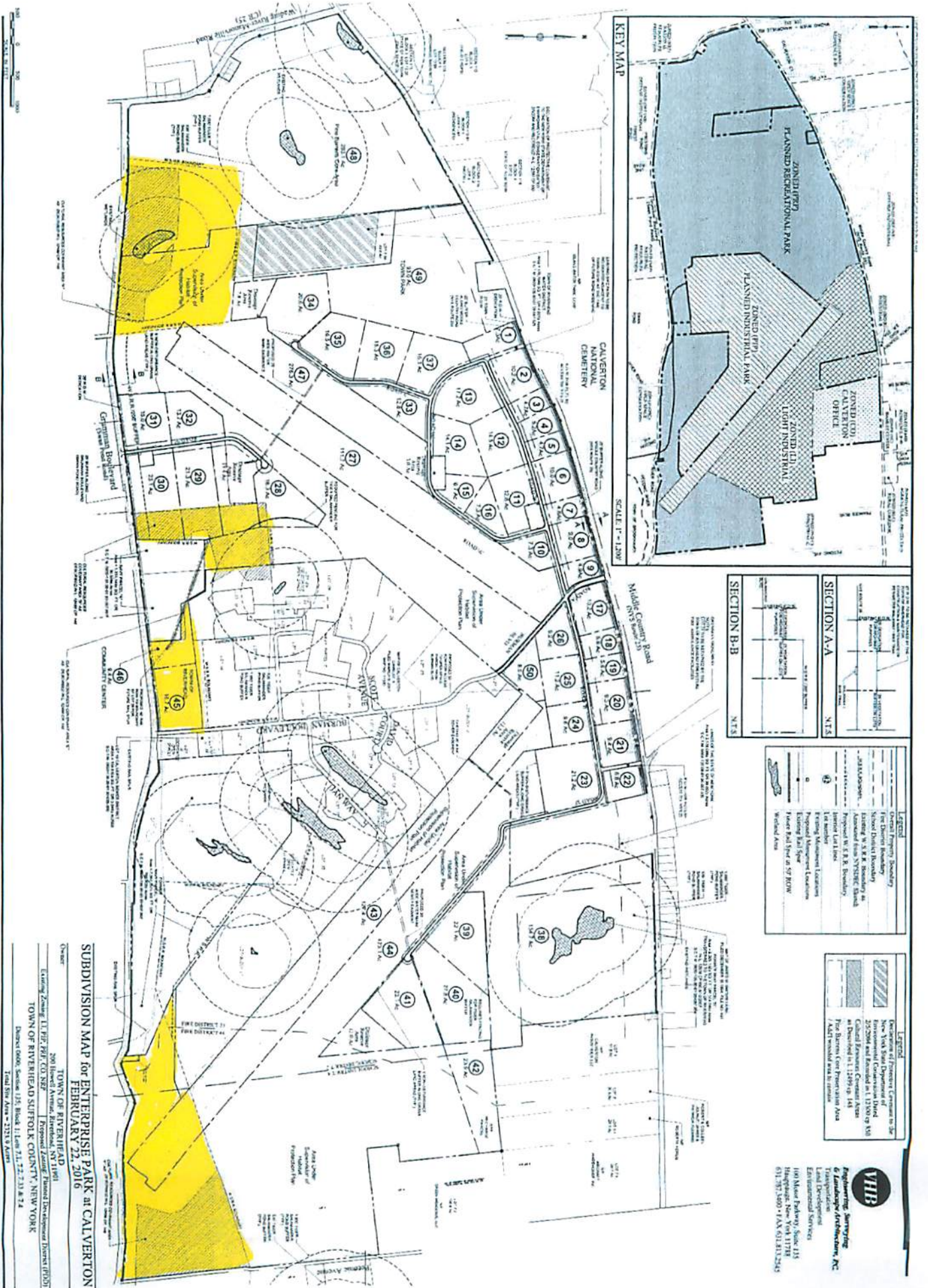

KEY MAP

SCALE 1" = 1.25"

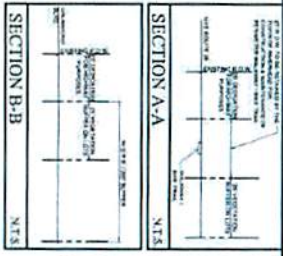

Legend	Description
	Current Property Boundary
	First Deeds Boundary
	Subdivided Boundary
	Existing S.W.R. Boundary as shown on 1978 Plat
	Proposed S.W.R. Boundary as shown on this Plat
	Proposed Management Location
	Existing Ball Spur
	Water Pad Spur at SW ROW
	Method Area

Legend	Description
	Designation of Proposed Extension to the Wild, Scenic and Recreational River of the Town of Riverhead, New York as shown on the 1978 Plat
	Designation of Proposed Extension to the Wild, Scenic and Recreational River of the Town of Riverhead, New York as shown on the 1978 Plat
	Proposed Management Location
	Existing Ball Spur
	Water Pad Spur at SW ROW
	Method Area

VHP
Vertical Planning, Surveying & Landscape Architecture, PC
 100 Meadow Parkway, Suite 115
 Hauppauge, New York 11788
 631.387.1500 • FAX 631.387.2545

SUBDIVISION MAP for ENTERPRISE PARK at CALVERTON
 FEBRUARY 22, 2016
 TOWN OF RIVERHEAD
 200 Liscoe Avenue, Riverhead, NY 11901
 Proposed Zoning: T.U.P.R. PLOT 02-88Z
 TOWN OF RIVERHEAD SUFFOLK COUNTY, NEW YORK
 District 0606, Section 125, Block 11, Lot 21, 22, 23, 31 & 34
 Total Site Area = 212.8 Acres

Owner: **Enterprise Park at Calverton**
 200 Liscoe Avenue, Riverhead, NY 11901
 Proposed Zoning: T.U.P.R. PLOT 02-88Z
 TOWN OF RIVERHEAD SUFFOLK COUNTY, NEW YORK
 District 0606, Section 125, Block 11, Lot 21, 22, 23, 31 & 34
 Total Site Area = 212.8 Acres